



Glass Divider

The Sneeze Guard Company

Project Name: _____

Location: _____

Item #: _____ Qty: _____

Date: _____

Model: **C110**

Class: Partition - Sneeze Guard - (vertical shield)

Model C110 is part of the Crystalline Series featuring the elegant all glass look. The C110 is characterized by the vertical front shield and in-line partition posts. The support posts are in-line with the partition glass creating a continuous flow to the sneeze guard and a clean look on the counter. The C110 only requires a 2" wide mounting surface and comes in 1/4" safety tempered glass. These partitions provide a maximum of 60" between supports. The C110 is available in four standard heights with custom sizes available. Always review your sneeze guard plans with your health department.

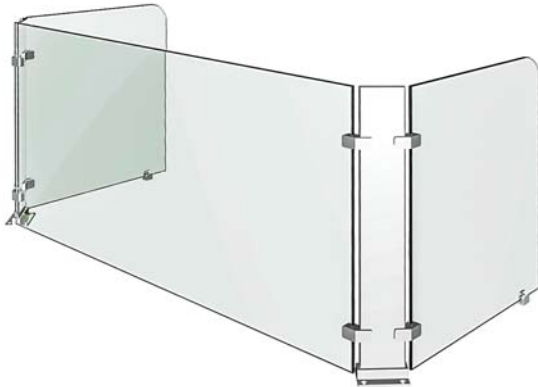
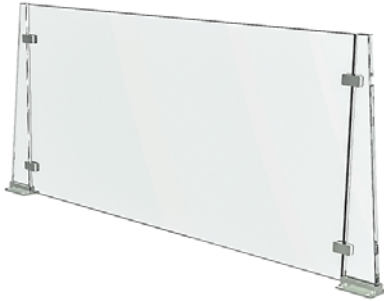

- Clear 1/2" Safety Tempered Glass Supports
- Narrow Mounting Space Required
- Four Standard Heights (18", 22", 24", and 26")
- 180°, 90°, and 45° Posts
- Two Standard Support Styles
- Chrome Finish Hardware

Support Options:

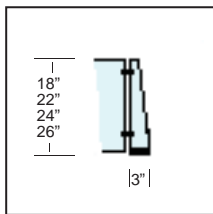

Tapered Post

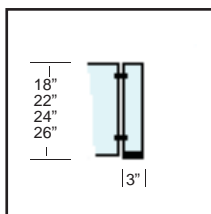

Square Post

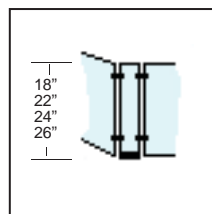

45° Corner

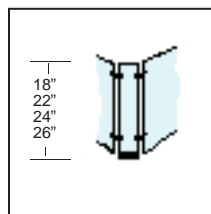

90° Corner

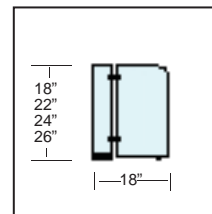

Deep
18" Depth

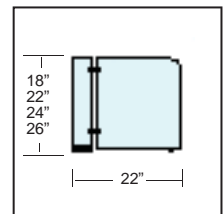

Extended
22" Depth

Options & Accessories

Glass Options

- 1/4" Glass
- Crystal Clear Glass
- Gray or Bronze Glass
- Pattern Glass
- Radius Corners
- Frosted Logo
- Frosted Glass

Mounting Options

- Mini Clamp
- Flanged Boot

Accessories

- LED Lights



NSF requires that end panels be a minimum depth of 18" from the front edge of the partition. The top edge of the sneeze guard needs to be a minimum of 60" above the floor.

